

# FLUSH PULLS

## GENERAL HARDWARE

### ARCHITECTURAL FLUSH PULLS

FP



FP231-180

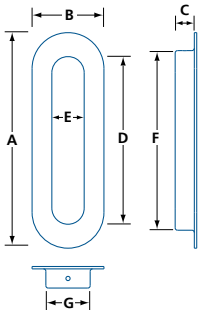

- For wood doors or panels
- Stainless steel
- Mounting screws included
- Back-to-back mounting possible

*Dimensions for reference only.  
Please request samples prior to door preparation.*

MODEL	FINISH	A	B	C	D	E	F	G
FP231-180	-630	7 <sup>3</sup> / <sub>32</sub> (180)	2 <sup>3</sup> / <sub>8</sub> (60)	<sup>9</sup> / <sub>16</sub> (14)	5 <sup>1</sup> / <sub>2</sub> (140)	1 <sup>1</sup> / <sub>16</sub> (26)	5 <sup>13</sup> / <sub>16</sub> (148)	1 <sup>7</sup> / <sub>16</sub> (37)

IN (MM)



FP225-50

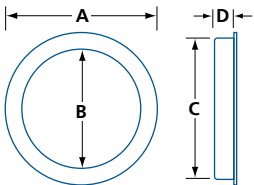

- For wood doors or panels
- Stainless steel
- Sizes 50 and 70 include mounting screws
- Back-to-back mounting possible

*Dimensions for reference only.  
Please request samples prior to door preparation.*



FP225-70



FP225-110

MODEL	FINISH	ø A	ø B	ø C	D	E	F	G
FP225-50	-630	2 (50)	1 <sup>1</sup> / <sub>4</sub> (31)	1 <sup>9</sup> / <sub>16</sub> (40)	<sup>7</sup> / <sub>16</sub> (10.7)	—	—	—
FP225-70	-630, -19	2 <sup>3</sup> / <sub>4</sub> (70)	2 (50)	2 <sup>3</sup> / <sub>8</sub> (60)	<sup>1</sup> / <sub>2</sub> (13.2)	—	—	—
FP225-110	-630	4 <sup>5</sup> / <sub>16</sub> (110)	3 <sup>3</sup> / <sub>8</sub> (86)	4 (102)	<sup>9</sup> / <sub>16</sub> (14)	—	—	—

IN (MM)

