

# HINGE PIN STOPS

## GENERAL HARDWARE

### HINGE PIN STOP – HEAVY DUTY

3509



3509

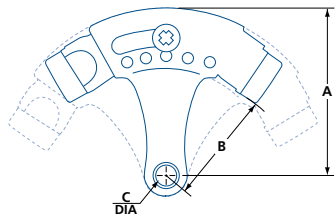

- For use on hinged doors
- Positive slip-proof adjustment
- 95 - 130° door opening adjustment
- Fits both  $\frac{1}{4}$ " (6mm) and  $\frac{5}{16}$ " (8mm) diameter hinge pins
- All steel construction
- Non-marring rubber tips

MODEL	FINISH	A	B	ø C	/ BOX
3509	C11P, C15, C15A, C19, C26D	$2\frac{1}{16}$ (52)	$1\frac{1}{2}$ (38)	$\frac{1}{4}$ (6.2)	25

IN (MM)

