

RIM CYLINDERS

SECURITY HARDWARE

RIM CYLINDER

MR

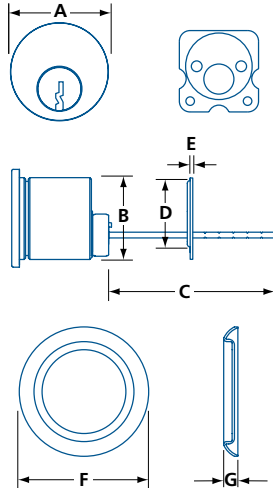

- Solid brass cylinder, trim ring included
- Cylinder length: 118 = 1 1/8" (28.6 mm)
- 6-pin, drilled for Construction Master Key (CMK)
- Keyways: Schlage (SC) or Weiser (WR)
- 2 keys included
- Tailpiece converts between horizontal and vertical positions
- Screw-on retaining cap

MR	118	-	WR	KD6	-	26D
MODEL	LENGTH		KEY	KEYING		FINISH

MODEL	øA	øB	C	D	E	F	G
MR	1 3/8 (34.5)	1 5/32 (29.1)	2 7/16 (60)	1 13/64 (31)	3/16 (1.2)	1 13/16 (45.8)	3/16 (5)

IN (MM)

MODEL	LENGTH	CAM	KEYWAY	KEYING*	PINS	FINISH	/CASE
MR	118	—	SC, WR	KD6	6	19, 26D	100

(*) FULL KEYING SERVICES AVAILABLE – PLEASE CONTACT

KD: KEYED DIFFERENT

RIM CYLINDER

CBR

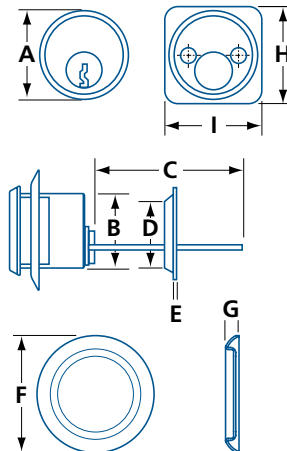

- Solid brass with aluminum clad face, trim ring included
- Cylinder length: 114 = 1 1/4" (32 mm)
- Keyways: 6-pin Schlage (SC) or special order 5-pin Yale #9 (Y9)
- 2 keys included
- Standard tailpiece and mounting hardware

CBR	114	-	Y9	KD	-	26D
MODEL	LENGTH		KEY	KEYING		FINISH

MODEL	øA	øB	C	D	E	F	G	H	I
CBR	1 3/8 (34.5)	1 5/32 (29.1)	2 7/16 (62)	1 5/32 (29.4)	1/16 (1.6)	1 9/16 (40)	7/32 (5.7)	1 5/16 (33)	1 5/16 (33)

IN (MM)

MODEL	LENGTH	CAM	KEYWAY	KEYING	PINS	FINISH	/CASE
CBR	114	—	SC, Y9*	KD	6	19, 26D	100

(*) SPECIAL ORDER

KD: KEYED DIFFERENT