

## Door Pulls & Plates Guide



## The Door Hardware Professionals

Canaropa is a leading contract manufacturer, importer and distributor of quality commercial, residential and architectural door hardware. The reliable choice of professionals, developers and architects – our products are found throughout North America in private homes, residential developments, offices, commercial and industrial buildings and resorts.

Since 1954, Canaropa has been offering an extensive selection of reliable, quality door hardware, including door closers, locks, hinges, exit devices, security hardware and more. Coupled with regional offices, warehouses, and large inventory, we provide fast and reliable service to our customers from coast to coast.

Canaropa is focused on delivering the best possible service to its customers. With our dedicated team of experienced door hardware professionals, management and sales teams – we work hard to meet the needs of our customers by developing new products, delivering consulting services and staying current with trends in the market.

## Professional & Technical Services

Whether it's a small residential project or a large multi-building development — Canaropa's hardware professionals can support you from the design stage all the way through to final construction.

Canaropa offers a variety of complimentary professional consulting and technical services to architects, designers and developers for commercial, residential, industrial, institutional, or hybrid projects:

### PROFESSIONAL SERVICES

- Door hardware specification writing, review and conversion.
- Architectural hardware consultation.
- Budget preparation.
- Review substitution requests.

### TECHNICAL SERVICES

- Technical project support and troubleshooting.
- Development and planning of common and high-security keying systems.
- In-house keying services – including high-security cylinders.
- Engraving services.

Our experienced hardware professionals are happy to help. They are well versed on local and national building codes, the unique needs of various types of facilities and egress requirements.

Take advantage of our experience and product knowledge today.

[www.canaropa.com](http://www.canaropa.com)



### DOOR PULLS

---

B Series - Cabinet Pulls - Round .....	4
Mitered Architectural Pulls .....	5
Ladder Architectural Pulls .....	7
Offset Architectural Pulls .....	9

### FLUSH-MOUNTED HANDLES

---

Flush Pulls .....	9
Edge Pulls .....	13

### MISCELLANEOUS

---

Bi-Fold Knobs .....	14
Door Pull with Back Plate .....	15
Door Pull .....	16
Finish Guide & Abbreviations .....	18

## B SERIES - CABINET PULLS – ROUND

DOREX



18R12BS-630

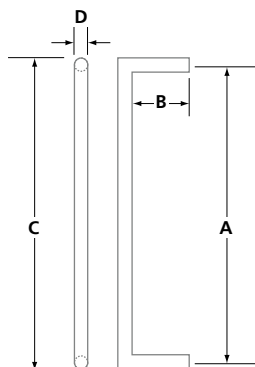

### 18R-B

- For wood or metal doors  $1\frac{3}{8}$ – $2\frac{1}{4}$ " (35–57 mm) thick
- For glass doors  $\frac{5}{16}$ – $\frac{1}{2}$ " (8–13 mm) thick
- Stainless steel
- Available in paired or single pulls
- Single pulls are thru-bolt mounted with round end-caps
- All necessary mounting hardware included



### 18R-BWBB-KIT-630 BOWL WASHERS

- Replaces included washers for an optional aesthetic look
- 2 Washers per kit

MODEL	TYPE <sup>1</sup>	FINISH	A	B	C	Ø D	/BOX
18R12B	B, S	-630, -19*	11 $\frac{13}{16}$ (300)	1 $\frac{3}{4}$ (44)	12 $\frac{9}{16}$ (319)	$\frac{3}{4}$ (19)	(B) 1 pair (S) 1 single
18R16B	B, S	-630, -19*	15 $\frac{3}{4}$ (400)	1 $\frac{3}{4}$ (44)	16 $\frac{1}{2}$ (419)	$\frac{3}{4}$ (19)	(B) 1 pair (S) 1 single
18R24B	B, S	-630, -19*	23 $\frac{5}{8}$ (600)	1 $\frac{3}{4}$ (44)	24 $\frac{3}{8}$ (619)	$\frac{3}{4}$ (19)	(B) 1 pair (S) 1 single

IN (MM) (1) B– PAIRED PULLS S–SINGLE PULL (\*) SPECIAL ORDER

DOREX



19R12BS-630

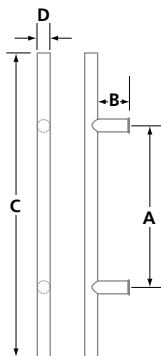

### 19R-B

- For wood or metal doors  $1\frac{3}{8}$ – $2\frac{1}{4}$ " (35–57 mm) thick
- For glass doors  $\frac{5}{16}$ – $\frac{1}{2}$ " (8–13 mm) thick
- Stainless steel
- Available in paired or single pulls
- Single pulls are thru-bolt mounted with round end-caps
- All necessary mounting hardware included



### 18R-BWBB-KIT-630 BOWL WASHERS

- Replaces included washers for an optional aesthetic look
- 2 Washers per kit

MODEL	TYPE <sup>1</sup>	FINISH	A	B	C	Ø D	/BOX
19R12B	B, S	-630, -19*	11 $\frac{13}{16}$ (300)	1 $\frac{3}{4}$ (44)	17 $\frac{3}{4}$ (450)	$\frac{3}{4}$ (19)	(B) 1 pair (S) 1 single
19R16B	B, S	-630, -19*	15 $\frac{3}{4}$ (400)	1 $\frac{3}{4}$ (44)	21 $\frac{5}{8}$ (550)	$\frac{3}{4}$ (19)	(B) 1 pair (S) 1 single
19R22B	B, S	-630, -19*	21 $\frac{5}{8}$ (550)	1 $\frac{3}{4}$ (44)	27 $\frac{9}{16}$ (700)	$\frac{3}{4}$ (19)	(B) 1 pair (S) 1 single

IN (MM) (1) B– PAIRED PULLS S–SINGLE PULL (\*) SPECIAL ORDER

630–Satin stainless steel 19–Matte black



DOREX



18R24E-630

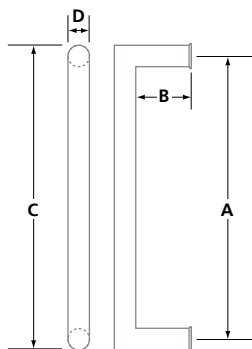
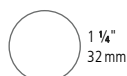

## 18R-E

- For wood or metal doors 1 3/8 – 2 1/4" (35–57 mm) thick
- For glass doors 5/16 – 1/2" (8–13 mm) thick
- Stainless steel
- Available in paired or single pulls
- Single pulls are thru-bolt mounted with round end-caps
- All necessary mounting hardware included
- Packaged in an eco-friendly, fully recyclable, box

MODEL	TYPE¹	FINISH	A	B	C	Ø D	/BOX
18R24E	B, S	-630, -19*	24 (610)	2 7/16 (62)	25 1/4 (641)	1 1/4 (32)	(B) 1 pair (S) 1 single
18R36E	B, S	-630, -19*	36 (915)	2 7/16 (62)	37 1/4 (946)	1 1/4 (32)	(B) 1 pair (S) 1 single
18R48E	B, S	-630, -19*	48 (1220)	2 7/16 (62)	49 1/4 (1251)	1 1/4 (32)	(B) 1 pair (S) 1 single
18R60E*	B, S	-630, -19	60 (1524)	2 7/16 (62)	61 1/4 (1556)	1 1/4 (32)	(B) 1 pair (S) 1 single
18R72E*	B, S	-630, -19	72 (1829)	2 7/16 (62)	73 1/4 (1861)	1 1/4 (32)	(B) 1 pair (S) 1 single

IN (MM) (1) B– PAIRED PULLS S–SINGLE PULL (\*) SPECIAL ORDER

DOREX



18Q24E-630

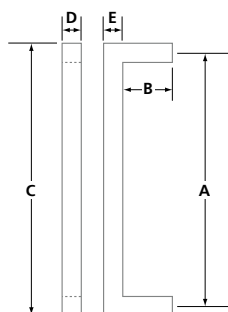
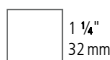

## 18Q-E

- For wood or metal doors 1 3/8 – 2 1/4" (35–57 mm) thick
- For glass doors 5/16 – 1/2" (8–13 mm) thick
- Stainless steel
- Available in paired or single pulls
- Single pulls are thru-bolt mounted with round end-caps
- All necessary mounting hardware included
- Packaged in an eco-friendly, fully recyclable, box

MODEL	TYPE¹	FINISH	A	B	C	D	E	/BOX
18Q24E	B, S	-630, -19*	24 (610)	2 7/16 (62)	25 1/4 (641)	1 1/4 (32)	1 1/4 (32)	(B) 1 pair (S) 1 single
18Q36E	B, S	-630, -19*	36 (915)	2 7/16 (62)	37 1/4 (946)	1 1/4 (32)	1 1/4 (32)	(B) 1 pair (S) 1 single
18Q48E	B, S	-630, -19*	48 (1220)	2 7/16 (62)	49 1/4 (1251)	1 1/4 (32)	1 1/4 (32)	(B) 1 pair (S) 1 single
18Q60E*	B, S	-630, -19	60 (1524)	2 7/16 (62)	61 1/4 (1556)	1 1/4 (32)	1 1/4 (32)	(B) 1 pair (S) 1 single
18Q72E*	B, S	-630, -19	72 (1829)	2 7/16 (62)	73 1/4 (1861)	1 1/4 (32)	1 1/4 (32)	(B) 1 pair (S) 1 single

IN (MM) (1) B– PAIRED PULLS S–SINGLE PULL (\*) SPECIAL ORDER

630–Satin stainless steel 19–Matte black

## MITERED ARCHITECTURAL PULLS

DOREX



18T24FS-630

1 1/2 x 1"  
38 x 25.4 mm

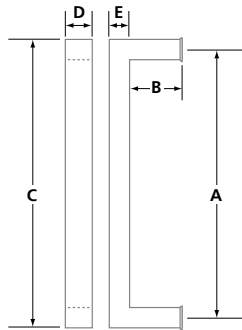

### 18T-F

- For wood or metal doors 1 3/8–2 1/4" (35–57mm) thick
- For glass doors 5/16–1/2" (8–13 mm) thick
- Stainless steel
- Available in paired or single pulls
- Single pulls are thru-bolt mounted with round end-caps
- All necessary mounting hardware included
- Packaged in an eco-friendly, fully recyclable, box

MODEL	TYPE <sup>1</sup>	FINISH	A	B	C	D	E	/BOX
18T24F	B, S	-630, -19*	24 (610)	2 5/8 (67)	25 (635)	1 1/2 (38)	1 (25.4)	(B) 1 pair (S) 1 single
18T36F	B, S	-630, -19*	36 (915)	2 5/8 (67)	37 (940)	1 1/2 (38)	1 (25.4)	(B) 1 pair (S) 1 single
18T48F	B, S	-630, -19*	48 (1220)	2 5/8 (67)	49 (1245)	1 1/2 (38)	1 (25.4)	(B) 1 pair (S) 1 single
18T60F*	B, S	-630, -19	60 (1524)	2 5/8 (67)	61 (1549)	1 1/2 (38)	1 (25.4)	(B) 1 pair (S) 1 single
18T72F*	B, S	-630, -19	72 (1829)	2 5/8 (67)	73 (1854)	1 1/2 (38)	1 (25.4)	(B) 1 pair (S) 1 single

IN (MM)

(1) B—PAIRED PULLS S—SINGLE PULL (\*) SPECIAL ORDER

## NOW AVAILABLE

# 45° Conversion Kit

## Install 19R-E Ladder Pulls at 45°

- Solid stainless steel
- Easy to convert
- Easy to install
- Available for single or paired pulls
  - Paired pulls #19R-B2B-POSTKIT45-630
  - Single pulls #19R-SING-POSTKIT45-630

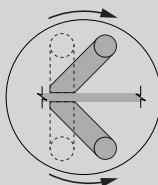

630—Satin stainless steel 19—Matte black

**NEW**

**DOREX  
316**



19R12ES-316

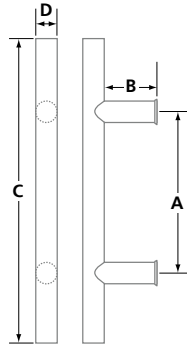

## 19R-E 316

- Marine grade, 316 stainless steel
- Ideal for outdoor use
- For wood or metal doors  $1\frac{3}{8}$ – $2\frac{1}{4}$ " (35–57 mm) thick
- For glass doors  $\frac{5}{16}$ – $\frac{1}{2}$ " (8–13 mm) thick
- Available in paired or single pulls
- Single pulls are thru-bolt mounted with round end-caps
- All necessary mounting hardware included
- Packaged in an eco-friendly, fully recyclable, box

MODEL	TYPE <sup>1</sup>	FINISH	A	B	C	ø D	/BOX
19R12E	B, S	316	12 (305)	$2\frac{7}{16}$ (62)	24 (610)	$1\frac{1}{4}$ (32)	(B) 1 pair (S) 1 single
19R24E	B, S	316	24 (610)	$2\frac{7}{16}$ (62)	36 (915)	$1\frac{1}{4}$ (32)	(B) 1 pair (S) 1 single
19R36E	B, S	316	36 (915)	$2\frac{7}{16}$ (62)	48 (1220)	$1\frac{1}{4}$ (32)	(B) 1 pair (S) 1 single
19R48E	B, S	316	48 (1220)	$2\frac{7}{16}$ (62)	60 (1524)	$1\frac{1}{4}$ (32)	(B) 1 pair (S) 1 single
19R60E*	B, S	316	60 (1524)	$2\frac{7}{16}$ (62)	72 (1829)	$1\frac{1}{4}$ (32)	(B) 1 pair (S) 1 single

IN (MM) (1) B– PAIRED PULLS S–SINGLE PULL (\*) SPECIAL ORDER

**DOREX**

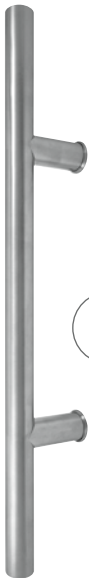

19R12ES-630

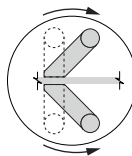
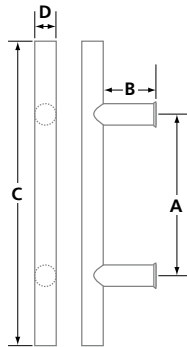

## 19R-E

- For wood or metal doors  $1\frac{3}{8}$ – $2\frac{1}{4}$ " (35–57 mm) thick
- For glass doors  $\frac{5}{16}$ – $\frac{1}{2}$ " (8–13 mm) thick
- Stainless steel
- Available in paired or single pulls
- Single pulls are thru-bolt mounted with round end-caps
- All necessary mounting hardware included
- Packaged in an eco-friendly, fully recyclable, box

- **45° Conversion kit available.** Allows 19RE pulls to be installed at 45°. Paired pulls #[19R-B2B-POSTKIT45-630](#)  
Single pulls #[19R-SING-POSTKIT45-630](#)

MODEL	TYPE <sup>1</sup>	FINISH	A	B	C	ø D	/BOX
19R12E	B, S	-630, -19*	12 (305)	$2\frac{7}{16}$ (62)	24 (610)	$1\frac{1}{4}$ (32)	(B) 1 pair (S) 1 single
19R24E	B, S	-630, -19*	24 (610)	$2\frac{7}{16}$ (62)	36 (915)	$1\frac{1}{4}$ (32)	(B) 1 pair (S) 1 single
19R36E	B, S	-630, -19	36 (915)	$2\frac{7}{16}$ (62)	48 (1220)	$1\frac{1}{4}$ (32)	(B) 1 pair (S) 1 single
19R48E	B, S	-630, -19	48 (1220)	$2\frac{7}{16}$ (62)	60 (1524)	$1\frac{1}{4}$ (32)	(B) 1 pair (S) 1 single
19R60E*	B, S	-630, -19	60 (1524)	$2\frac{7}{16}$ (62)	72 (1829)	$1\frac{1}{4}$ (32)	(B) 1 pair (S) 1 single
19R72E*	B, S	-630, -19	72 (1829)	$2\frac{7}{16}$ (62)	84 (2134)	$1\frac{1}{4}$ (32)	(B) 1 pair (S) 1 single

IN (MM) (1) B– PAIRED PULLS S–SINGLE PULL (\*) SPECIAL ORDER

630–Satin stainless steel 19–Matte black

# LADDER ARCHITECTURAL PULLS

DOREX



19Q12ES-630

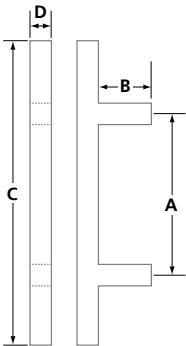
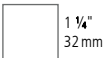

### 19Q-E

- For wood or metal doors 1 3/8–2 1/4" (35–57 mm) thick
- For glass doors 5/16– 1/2" (8–13 mm) thick
- Stainless steel
- Available in paired or single pulls
- Single pulls are thru-bolt mounted with round end-caps
- All necessary mounting hardware included
- Packaged in an eco-friendly, fully recyclable, box

MODEL	TYPE¹	FINISH	A	B	C	ø D	/BOX
19Q12E	B, S	-630, -19*	12 (305)	2 7/16 (62)	24 (610)	1 1/4 (32)	(B) 1 pair (S) 1 single
19Q24E	B, S	-630, -19*	24 (610)	2 7/16 (62)	36 (915)	1 1/4 (32)	(B) 1 pair (S) 1 single
19Q36E	B, S	-630, -19*	36 (915)	2 7/16 (62)	48 (1220)	1 1/4 (32)	(B) 1 pair (S) 1 single
19Q48E	B, S	-630, -19*	48 (1220)	2 7/16 (62)	60 (1524)	1 1/4 (32)	(B) 1 pair (S) 1 single
19Q60E*	B, S	-630, -19	60 (1524)	2 7/16 (62)	72 (1829)	1 1/4 (32)	(B) 1 pair (S) 1 single
19Q72E*	B, S	-630, -19	72 (1829)	2 7/16 (62)	84 (2134)	1 1/4 (32)	(B) 1 pair (S) 1 single

IN (MM) (1) B— PAIRED PULLS S—SINGLE PULL (\*) SPECIAL ORDER

630—Satin stainless steel 19—Matte black



DOREX



20R10ES-630

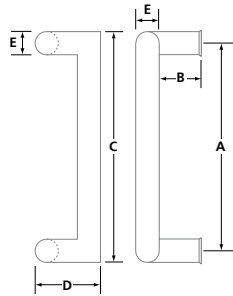
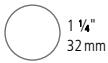

## 20R-E

- For wood or metal doors  $1\frac{3}{8}$ – $2\frac{1}{4}$ " (35–57 mm) thick
- For glass doors  $\frac{9}{16}$ – $\frac{1}{2}$ " (8–13 mm) thick
- Stainless steel
- Available in paired or single pulls
- Single pulls are thru-bolt mounted with round end-caps
- All necessary mounting hardware included
- Packaged in an eco-friendly, fully recyclable, box

MODEL	TYPE <sup>1</sup>	FINISH	A	B	C	D	Ø E	/BOX
20R10E	B, S	-630, -19*	10 (254)	$2\frac{7}{16}$ (62)	$11\frac{1}{4}$ (286)	4 (102)	$1\frac{1}{4}$ (32)	(B) 1 pair (S) 1 single
20R24E	B, S	-630, -19*	24 (609.6)	$2\frac{7}{16}$ (62)	$25\frac{1}{4}$ (641)	4 (102)	$1\frac{1}{4}$ (32)	(B) 1 pair (S) 1 single
20R36E	B, S	-630, -19*	36 (914.4)	$2\frac{7}{16}$ (62)	$37\frac{1}{4}$ (946)	4 (102)	$1\frac{1}{4}$ (32)	(B) 1 pair (S) 1 single
20R48E	B, S	-630, -19*	48 (1219.2)	$2\frac{7}{16}$ (62)	$49\frac{1}{4}$ (1251)	4 (102)	$1\frac{1}{4}$ (32)	(B) 1 pair (S) 1 single
20R60E*	B, S	-630, -19	60 (1524)	$2\frac{7}{16}$ (62)	$61\frac{1}{4}$ (1556)	4 (102)	$1\frac{1}{4}$ (32)	(B) 1 pair (S) 1 single

IN (MM) (1) B– PAIRED PULLS S–SINGLE PULL (\*) SPECIAL ORDER

DOREX



20T10ES-630

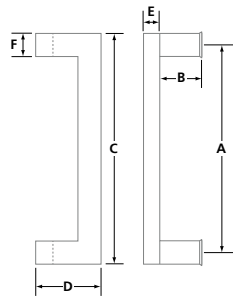
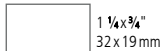

## 20T-E

- For wood or metal doors  $1\frac{3}{8}$ – $2\frac{1}{4}$ " (35–57 mm) thick
- For glass doors  $\frac{9}{16}$ – $\frac{1}{2}$ " (8–13 mm) thick
- Stainless steel
- Available in paired or single pulls
- Single pulls are thru-bolt mounted with round end-caps
- All necessary mounting hardware included
- Can be installed on 2" (51 mm) aluminum doors and frame with  $\frac{1}{2}$ " (12.7 mm) door stop
- Packaged in an eco-friendly, fully recyclable, box

MODEL	TYPE <sup>1</sup>	FINISH	A	B	C	D	E	F	/BOX
20T10E	B, S	-630, -19*	10 (254)	$2\frac{11}{16}$ (68)	$11\frac{1}{4}$ (286)	4 (102)	$\frac{3}{4}$ (19)	$1\frac{1}{4}$ (32)	(B) 1 pair (S) 1 single
20T24E	B, S	-630, -19*	24 (609.6)	$2\frac{11}{16}$ (68)	$25\frac{1}{4}$ (641)	4 (102)	$\frac{3}{4}$ (19)	$1\frac{1}{4}$ (32)	(B) 1 pair (S) 1 single
20T36E	B, S	-630, -19*	36 (914.4)	$2\frac{11}{16}$ (68)	$37\frac{1}{4}$ (946)	4 (102)	$\frac{3}{4}$ (19)	$1\frac{1}{4}$ (32)	(B) 1 pair (S) 1 single
20T48E	B, S	-630, -19*	48 (1219.2)	$2\frac{11}{16}$ (68)	$49\frac{1}{4}$ (1251)	4 (102)	$\frac{3}{4}$ (19)	$1\frac{1}{4}$ (32)	(B) 1 pair (S) 1 single
20T60E*	B, S	-630, -19	60 (1524)	$2\frac{11}{16}$ (68)	$61\frac{1}{4}$ (1556)	4 (102)	$\frac{3}{4}$ (19)	$1\frac{1}{4}$ (32)	(B) 1 pair (S) 1 single

IN (MM) (1) B– PAIRED PULLS S–SINGLE PULL (\*) SPECIAL ORDER

630–Satin stainless steel 19–Matte black

# FLUSH PULLS



FP414-60-630



FP410-135-630



FPC402-135-630



FP416-300-630



FPC406-300-630

- For wood doors and panels
- Stainless steel with plastic components
- Available with or without spring cover

*Dimensions for reference only.*

*Please request samples prior to door preparation.*

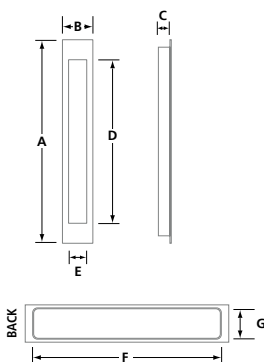

MODEL	FINISH	A	B	C	D	E	F	G
FP410-135	-629, -630	5 <sup>5</sup> / <sub>16</sub> (135)	2 <sup>3</sup> / <sub>4</sub> (70)	1 <sup>1</sup> / <sub>16</sub> (17)	3 <sup>15</sup> / <sub>16</sub> (100)	1 (25)	4 <sup>15</sup> / <sub>16</sub> (125)	1 <sup>13</sup> / <sub>16</sub> (46)
FP412-135	-629, -630	5 <sup>5</sup> / <sub>16</sub> (135)	2 <sup>3</sup> / <sub>16</sub> (55)	1 <sup>1</sup> / <sub>16</sub> (17)	3 <sup>15</sup> / <sub>16</sub> (100)	1 (25)	4 <sup>15</sup> / <sub>16</sub> (125)	1 <sup>13</sup> / <sub>16</sub> (46)
FP414-60	-629, -630	2 <sup>3</sup> / <sub>8</sub> (60)	2 <sup>3</sup> / <sub>8</sub> (60)	1 <sup>1</sup> / <sub>16</sub> (17)	1 <sup>3</sup> / <sub>16</sub> (30)	1 <sup>3</sup> / <sub>16</sub> (30)	2 (50)	2 (50)
FP416-300	-629, -630	11 <sup>13</sup> / <sub>16</sub> (300)	2 <sup>3</sup> / <sub>16</sub> (55)	1 <sup>1</sup> / <sub>16</sub> (17)	1 (25)	1 (25)	10 <sup>7</sup> / <sub>8</sub> (276)	1 <sup>13</sup> / <sub>16</sub> (46)
WITH SPRING COVER								
FPC402-135*	-629, -630	5 <sup>5</sup> / <sub>16</sub> (135)	2 <sup>3</sup> / <sub>16</sub> (55)	1 <sup>1</sup> / <sub>16</sub> (17)	3 <sup>15</sup> / <sub>16</sub> (100)	1 (25)	4 <sup>15</sup> / <sub>16</sub> (125)	1 <sup>13</sup> / <sub>16</sub> (46)
FPC406-300*	-629, -630	11 <sup>13</sup> / <sub>16</sub> (300)	2 <sup>3</sup> / <sub>16</sub> (55)	1 <sup>1</sup> / <sub>16</sub> (17)	9 <sup>13</sup> / <sub>16</sub> (250)	1 (25)	10 <sup>15</sup> / <sub>16</sub> (278)	1 <sup>13</sup> / <sub>16</sub> (46)

IN (MM) (\*) SPECIAL ORDER



FP224-70-630



FP225-110-630



FP231-180-630

- For wood doors
- Stainless steel
- Round backplate for easy installation
- Back-to-back mounting possible

*Dimensions for reference only.*

*Please request samples prior to door preparation.*

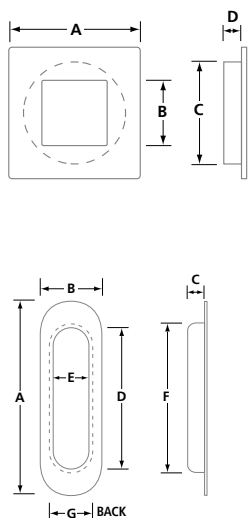

MODEL	FINISH	A	B	ø C	D	E	F	G
FP224-70	-630	2 <sup>3</sup> / <sub>4</sub> (70)	1 <sup>9</sup> / <sub>16</sub> (40)	2 <sup>3</sup> / <sub>8</sub> (60)	5 <sup>5</sup> / <sub>8</sub> (15)	1 (25)	—	—
FP224-110	-630	4 <sup>5</sup> / <sub>16</sub> (110)	2 <sup>11</sup> / <sub>16</sub> (68)	4 (102)	5 <sup>5</sup> / <sub>8</sub> (15)	1 <sup>5</sup> / <sub>16</sub> (34)	—	—
FP225-110	-630	ø 4 <sup>5</sup> / <sub>16</sub> (110)	ø 3 <sup>3</sup> / <sub>8</sub> (86)	4 (102)	9 <sup>9</sup> / <sub>16</sub> (14)	—	—	—
FP231-180	-630	7 <sup>3</sup> / <sub>32</sub> (180)	2 <sup>3</sup> / <sub>8</sub> (60)	9 <sup>9</sup> / <sub>16</sub> (14)	5 <sup>1</sup> / <sub>2</sub> (140)	1 <sup>1</sup> / <sub>16</sub> (26)	5 <sup>13</sup> / <sub>16</sub> (148)	1 <sup>7</sup> / <sub>16</sub> (37)

IN (MM)

629—Polished stainless steel 630—Satin stainless steel 19—Matte black

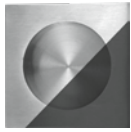

FP223R-64-630  
FP223R-64-19



FP223-70-630  
FP223-70-19



FP225-70-630  
FP225-70-19

- For wood doors
- Stainless steel
- Round backplate for easy installation
- Back-to-back mounting possible

*Dimensions for reference only.*

*Please request samples prior to door preparation.*

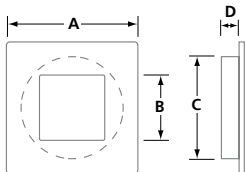

MODEL	FINISH	A	B	ø C	D
FP223R-64	-630, -19	2 1/2 (64)	1 3/4 (45)	2 1/8 (54)	1/2 (12.7)
FP223-50	-630	2 (50)	Z (26)	1 9/16 (40)	7/16 (11.5)
FP223-70	-630, -19	2 3/4 (70)	1 9/16 (40)	2 3/8 (60)	1/2 (13.2)
FP225-50	-630	2 (50)	1 1/4 (31)	1 9/16 (40)	7/16 (10.7)
FP225-70	-630, -19	2 3/4 (70)	2 (50)	2 3/8 (60)	1/2 (13.2)

IN (MM)



FP227-120-630  
FP227-120-19



FP228-120-630  
FP228-120-19



FP412-135-630  
FP412-135-19

- For wood doors
- Stainless steel
- Back-to-back mounting possible

*Dimensions for reference only.*

*Please request samples prior to door preparation.*

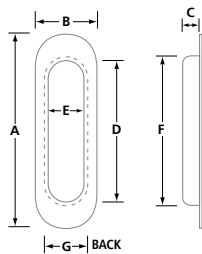

MODEL	FINISH	A	B	C	D	E	F	G
FP227-120	-630, -19	4 1/16 (120)	1 5/8 (40)	7/16 (11)	3 5/16 (85)	7/8 (22)	3 5/8 (92)	1 1/16 (27)
FP228-120	-630, -19	4 1/16 (120)	1 5/8 (40)	7/16 (11)	3 5/16 (85)	7/8 (22)	3 5/8 (92)	1 1/16 (27)
FP231-180	-630	6 1/16 (175)	2 3/8 (60)	9/16 (14)	5 1/2 (140)	1 1/16 (26)	5 13/16 (148)	1 7/16 (37)
FP412-135B	-630, -19	5 5/16 (135)	2 3/16 (55)	7/16 (11.5)	3 15/16 (100)	1 (25)	4 1/2 (114.5)	1 1/4 (32)

IN (MM)

## FLUSH PULLS – MISCELLANEOUS



2530C26-CHR

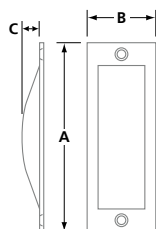

- For wood doors
- Steel
- Wood screws included

MODEL	FINISH	A	B	C	CUT-OUT DIMENSION	/BOX
2530	BP, C11P, C15, C15A, C19, CHR, C26D	4½ (114)	1⅝ (40)	½ (12.7)	1 ⅝ x 3 ½ x ½ (33.3 x 89 x 12.7)	50

IN (MM)



3503-26D

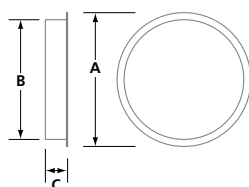

- For wood doors
- Steel
- Fasteners NOT included

MODEL	FINISH	øA	øB	C	CUT-OUT DIMENSION	/BOX
3503	11P, 15, 15A, 19, 26, 26D	2 ⅞ (62)	2 ⅞ (52)	⅜ (9.5)	2 ⅞ DIA x 1/2 (54 DIA x 12.7)	100

IN (MM)



4100SS

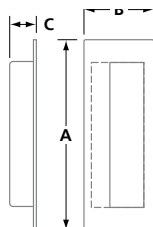

- For wood doors
- Stainless steel
- Fasteners NOT included

MODEL	FINISH	A	B	C	CUT-OUT DIMENSION	/BOX
4100SS	Stainless steel	4½ (114)	1⅝ (40)	½ (12.7)	1 ⅝ x 3 ¾ x ⅝ (33.3 x 95 x 15.9)	25

IN (MM)

BP–Polished brass C11P–Antique bronze C15–Satin nickel C15A–Antique Nickel  
19–Matte black 26D–Satin chrome CHR/26–Polished chrome



EP310-30-630

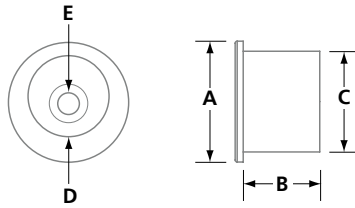

- For wood panels
- Stainless steel
- Wood screws included

MODEL	FINISH	MATERIAL	ø A	B	ø C	ø D	ø E
EP310-30	-630	Stainless Steel	1 3/16 (30)	3/4 (19.5)	1 (25)	13/16 (20.5)	3/16 (4.5)

IN (MM)



EP312-154-630

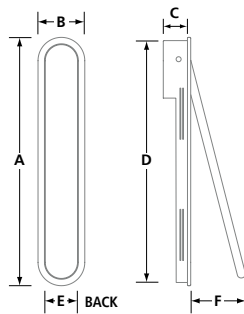

- For wood panels or doors
- Stainless steel

MODEL	FINISH	MATERIAL	A	B	C	D	E	F
EP312-154	-630	Stainless Steel	6 3/16 (158)	1 3/16 (30)	5/8 (16)	5 13/16 (151)	1 (25)	3 5/16 (84)

IN (MM)



3512-32D

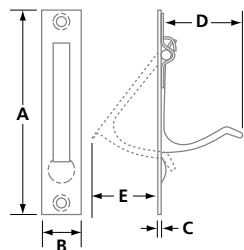

- Brass
- Wood screws included

MODEL	FINISH	MATERIAL	A	B	C	D	E	/BOX
3512	-32D	Brass	3 7/8 (98)	3/4 (19.1)	5/64 (2)	1 1/16 (39.6)	1 1/4 (31.8)	25

IN (MM)

630/32D-Satin stainless steel

BI-FOLD DOOR PULLS



3520C26D

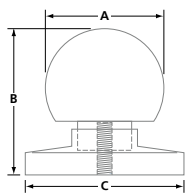

• For 1 3⁄8" (35 mm) thick doors

MODEL	FINISH	MATERIAL	ø A	B	ø C	/BOX
3520	C3, C5, C11P, C15, C15A, C19, C26, C26D	Zinc die-cast	1 1⁄4 (31.8)	1 5⁄8 (41.3)	1 3⁄4 (44.5)	50

IN (MM)



3521C26

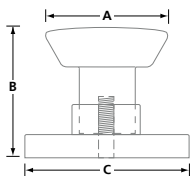

• For 1 3⁄8" (35 mm) thick doors

MODEL	FINISH	MATERIAL	ø A	B	ø C	D
3521	C15, C19, C26, C26D	Zinc die-cast	1 1⁄4 (31.8)	1 1⁄16 (17)	1 (25)	3⁄4 (20.5)

IN (MM)

C3–Polished brass C5–Antique brass C11P–Antique bronze C15–Satin nickel  
C15A–Antique nickel C19–Matte black C26–Polished chrome C26D–Satin chrome

## DOOR PULL WITH BACK PLATE



H1410

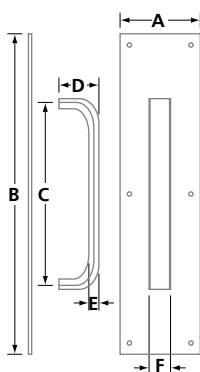

- D-Type door pull
- Supplied with six #6 x  $\frac{3}{4}$ " (19.1 mm) long wood screws, two  $\frac{1}{4}$ -20 UNC x 2  $\frac{3}{8}$ " (60 mm) long machine screws and cup-washers

MODEL	MATERIAL	A	B	C	D	E	F
H1410	Aluminum	4 (102)	16 (406)	9 (229)	2 $\frac{1}{16}$ (52)	$\frac{1}{2}$ (12.7)	1 $\frac{1}{16}$ (26.9)
H1411	Aluminum	3 $\frac{1}{2}$ (89)	15 (381)	7 (178)	2 $\frac{1}{16}$ (52)	$\frac{1}{2}$ (12.7)	1 $\frac{1}{16}$ (26.9)

IN (MM)

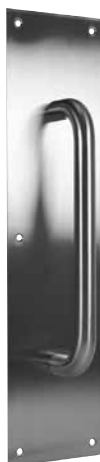

14R09P-32D

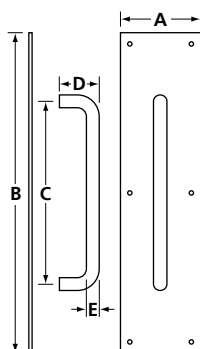

- Round door pull
- Supplied with six #6 x  $\frac{3}{4}$ " (19.1 mm) long wood screws, two  $\frac{1}{4}$ -20 UNC x 2  $\frac{3}{8}$ " (60 mm) long machine screws and cup-washers

MODEL	FINISH	MATERIAL	A	B	C	D	ØE
14R09P	32D	Stainless steel	4 (102)	16 (406)	9 (229)	2 $\frac{1}{4}$ (57)	$\frac{3}{4}$ (19.1)

IN (MM)

C28–Aluminum C32D–Satin stainless steel

DOOR PULLS

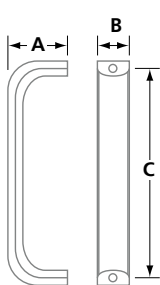

- Supplied with two 1/4-20 UNC x 2 3/8 (60mm) long flat-head machine screws and cup-washers

MODEL	FINISH	MATERIAL	A	B	C
H1412	-C28	Aluminum	2 (50.8)	1 1/16 (26.9)	7 (178)
H1413	-C28	Aluminum	2 (50.8)	1 1/16 (26.9)	9 (229)
14R09	-C32D	Stainless steel	2 (50.8)	3/4 (19.1)	9 (229)

IN (MM)

C28–Aluminum C32D–Satin stainless steel



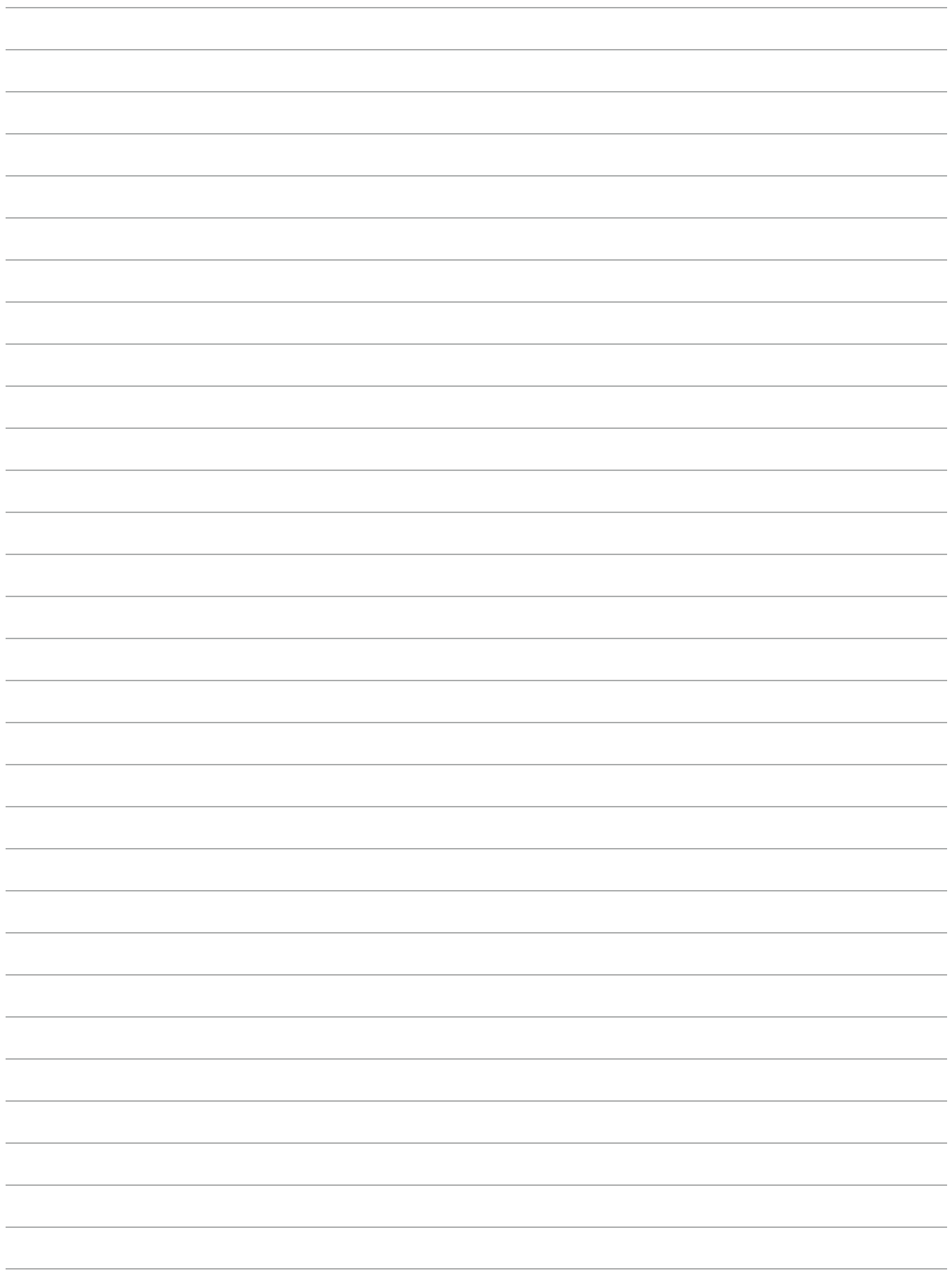

# GENERAL INFORMATION

## FINISH GUIDE

					
	POLISHED BRASS	ANTIQUE BRASS	ANTIQUE BRONZE	SATIN NICKEL	ANTIQUE NICKEL
CODE	BP, BP032, C3, 3	AB, C5, 5	C11P, 11P	SDN, C15, 15	C15A, 15A
BHMA*	605, 632	609, 638	617, 644	619, 646	620, 647
					
	MATTE BLACK	POLISHED CHROME	SATIN CHROME	POLISHED STAINLESS STEEL	SATIN STAINLESS STEEL
CODE	C19, 19	CHR, C26, 26	C26D, 26D	C32, 32	SS, C32D, 32D
BHMA*	622, 631	625, 651	262, 652	629	630
					
	ALUMINUM				
CODE	AL, C28, 28				
BHMA*	628, 689				

ALL FINISHES IMAGES ABOVE ARE PHOTOGRAPHIC OR COLOUR APPROXIMATIONS, DELIVERED PRODUCT MAY VARY IN COMPARISON OR BETWEEN ORDERS/LOTS.  
**OTHER FINISHES AVAILABLE—PLEASE CONTACT.**  
 (\*) EQUIVALENT; CODES DIFFER DEPENDING ON BASE MATERIAL AND/OR FINISH PROCESS.

## ABBREVIATIONS

### GENERAL

BS	Backset
DIA, ∅	Diameter
KG	Kilograms
LBS	Pounds
LH	Left hand
LHR	Left hand reversed
MAX	Maximum
MIN	Minimum
N/A, —	Not applicable / Not available
QTY	Quantity (usually followed by notes)
RH	Right hand
RHR	Right hand reversed
SQ, ∅	Square
WT	Weight
/UNIT	Number of items per basic unit of sale (bagged or boxed)
/BOX, /BAG	Number of UNITS found in an inner carton or bag
/CASE	Number of BOXES or UNITS found in an outer (shipping) carton

# DOREX<sup>®</sup> 316

**Marine Grade Stainless Steel  
Architectural Door Pulls**

**NEW**



**Unique Ecofriendly packaging**  
**Low Maintenance**  
**Ideal for Outdoor Applications**

