

# PF163 WALL MOUNT TRANSOM PATCH FITTING WITH DOOR STOP INSTALLATION INSTRUCTIONS

DOOR THICKNESS: 8 mm to 12.7 mm (5/16" to 1/2")  
DOOR WIDTH: MAX. 1000 mm (39-3/8")  
DOOR WEIGHT: MAX. 100 kg (220 lbs)

## WALL MOUNT TRANSOM PATCH WITH DOOR STOP PF163 WITH WALL MOUNT BRACKET

⚠ ALL CLEARANCES AROUND  
THE GLASS DOOR ARE FOR  
REFERENCE ONLY

FIG.1

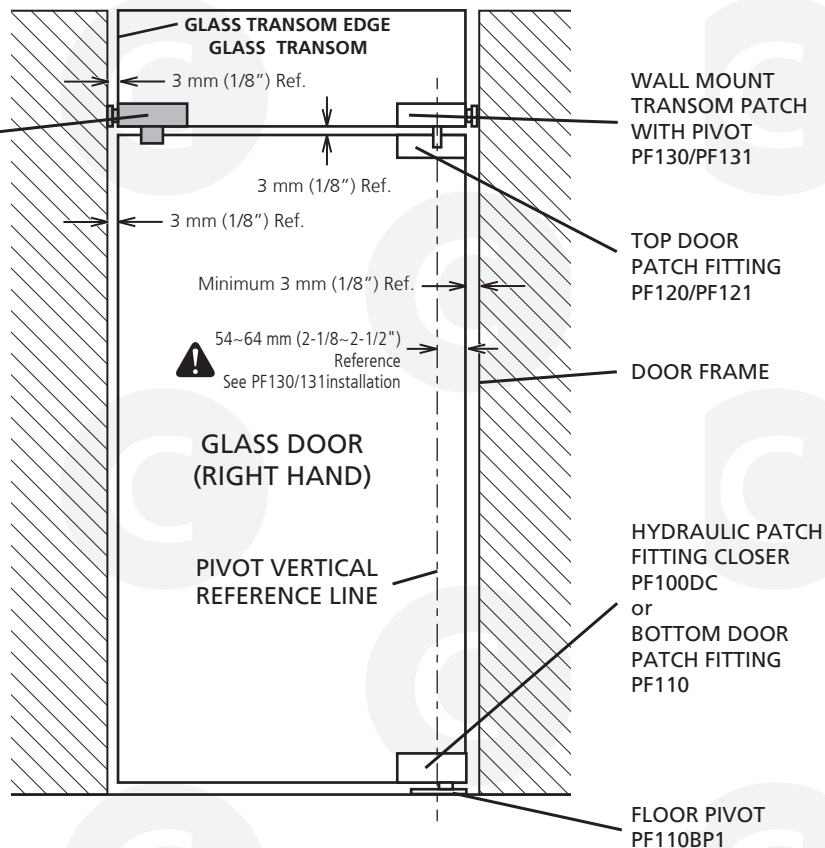

DIMENSIONS :  $\frac{\text{mm}}{\text{INCH (ref.)}}$

⚠ DRAWING NOT TO SCALE  
DO NOT USE AS TEMPLATE

## GLASS TRANSOM CUT FOR PF163 (RIGHT HAND)

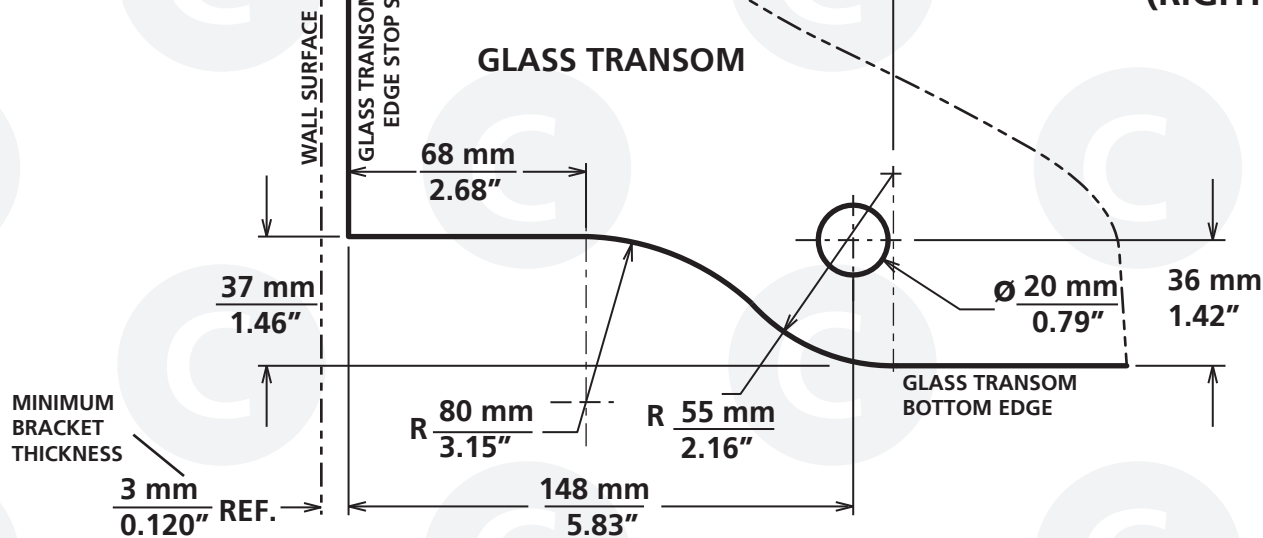

FIG.2

# PF163 WALL MOUNT TRANSOM PATCH FITTING WITH DOOR STOP INSTALLATION INSTRUCTIONS

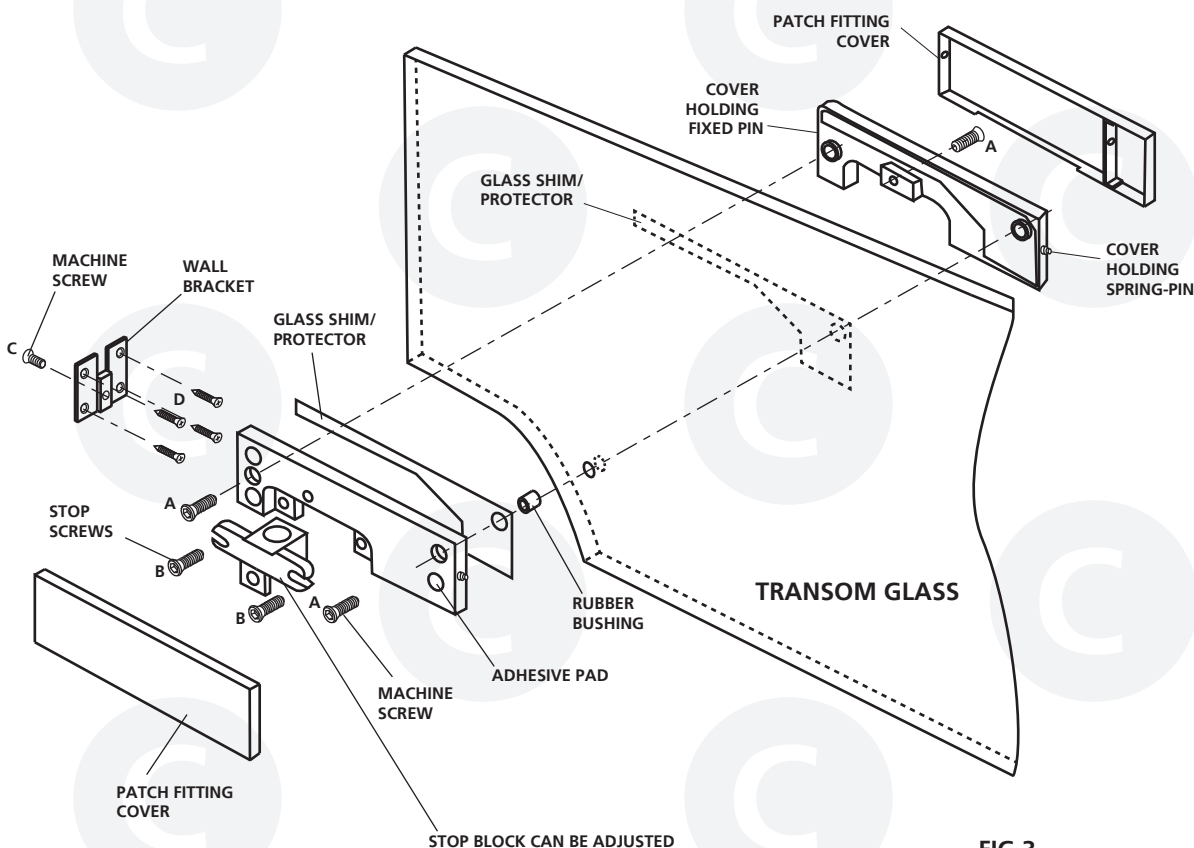

FIG.3

## INSTALLATION INSTRUCTIONS:

1. Prepare and make cuts on the glass transom (refer to the dimensions supplied in fig.2).
2. Attach wall bracket to the patch stop with supplied machine screw (C).
3. Insert rubber bushing in to glass hole and position stop patch on glass transom (refer to fig. 3), shim as required to accommodate glass thickness and fasten assembly with the three (3) supplied machine screws (A).  
**⚠ There must be no direct contact between any metal part of the patch fitting and the glass.**
4. Attach wall bracket to wall using supplied mounting hardware (D), or using other suitable hardware.
5. Close door and verify door stop is properly positioned.
6. Adjust stop as required and secure stop in place using stop screws (B)
7. Install adhesive pads and stainless steel patch covers. To install cover, position the cover over the patch body and start by pushing the far edge (away from the wall) to align over the spring pin then push the cover towards the wall (the spring pin will lower) while lowering the near edge (towards the wall) over the holding-pin. Release the pressure towards the wall and the cover will snap into place.
8. To remove a cover, push cover towards the wall side (the spring pin will lower) and pull out cover from the fixed pin first, then pull out from the other end.